

圖例 LEGEND

Legend table with symbols for Boundary of the Scheme, Proposed Railway Station, Proposed Bored/Mined Tunnel, Existing Station, Drawing Revision, etc.

說明 NOTES

此圖根據第 KTE-G07 號 (修改) 圖則制訂, 分別以紅色和深綠色標明將永久封閉的忠義街和常樂街路段的部分行人路路面, 以及以橙色標明將永久封閉連接佛光街和忠義街的行人路路段。

一般說明 GENERAL NOTES

- 1. 切面圖所示鐵路設施的形狀和輪廓均屬示意性質。 GEOMETRY AND CONFIGURATION OF RAILWAY FACILITIES SHOWN IN SECTIONS ARE SCHEMATIC.
2. 所有在方案界線內的道路 (包括行車道、行人徑及露天地方)...

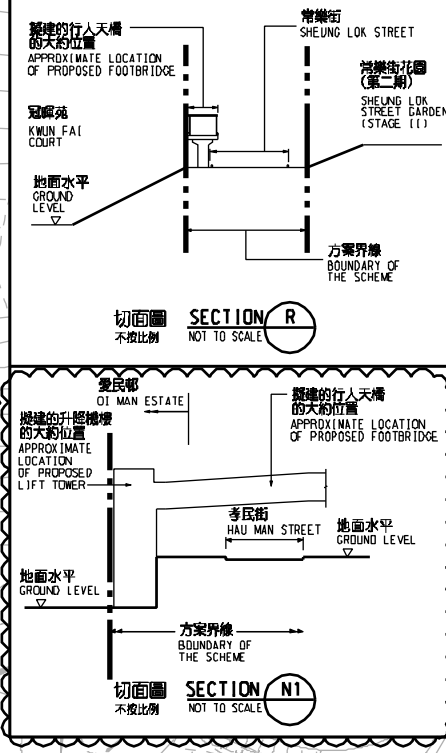
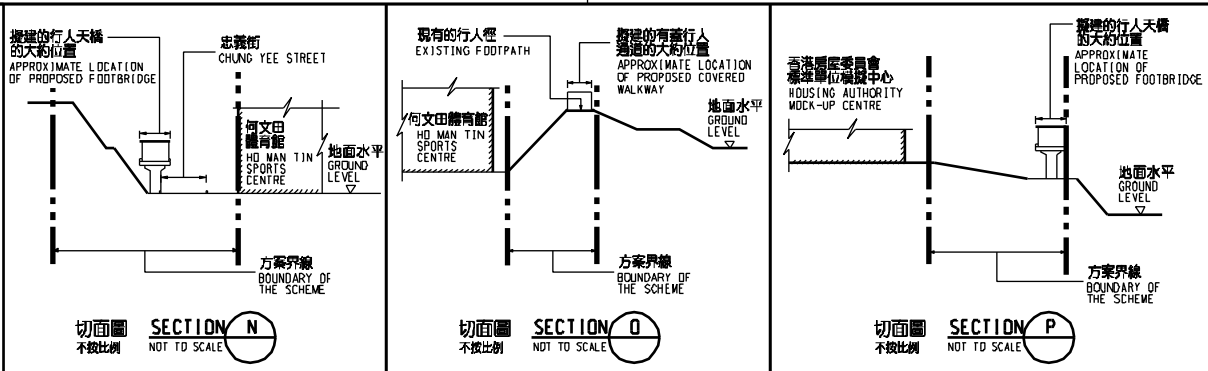
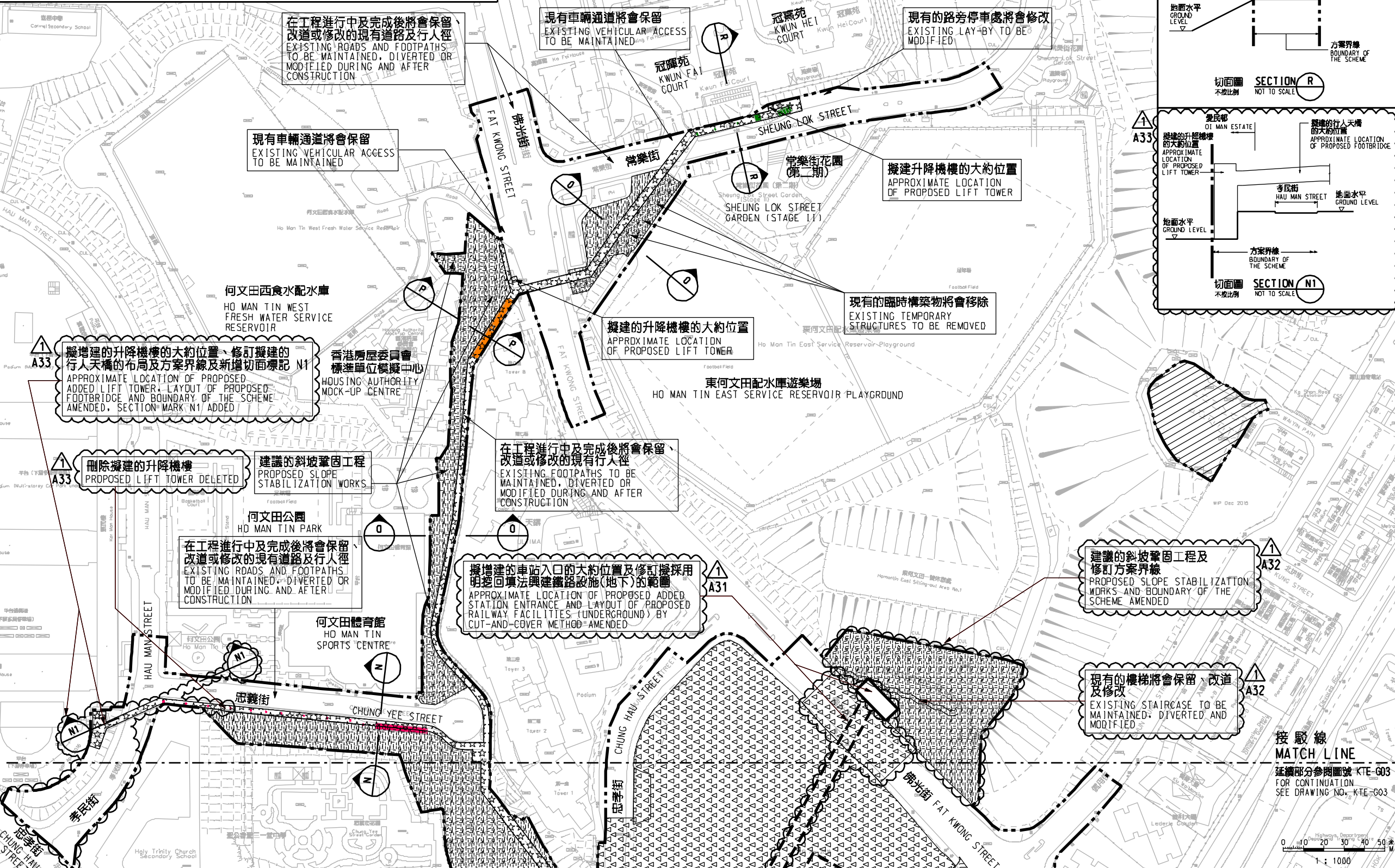

一般說明 GENERAL NOTES

- 1. 有關一般說明參閱圖號 KTE - G01。 FOR GENERAL NOTES, REFER TO DRAWING NO. KTE - G01.

Table of Amendments with columns: Rev, Date, By, Sub, App, Description.

SIGNED: 王偉光 STEPHEN W. WONG, 8/9/2016, HIGHWAYS DEPARTMENT.

鐵路條例 (第 519 章) 觀塘線延續, 永久封閉忠義街和常樂街路段, 以及連接佛光街和忠義街的行人路路段.

Project information including drawing title, number (KTE/G07/0009/1), scale (1:1000), and logos of the Government and Railways Development Office.

Vertical text on the left edge: PLOT, DRW, PRINTED BY, FILE NAME.